

# monitor

the world's  
best equipment  
supported  
locally

Sales | Service | Parts | Hire | Finance

## Monitor E290PX Truck Mounted Lift

Hino FG1628

1800 025 024  
[monitor.net.au](http://monitor.net.au)

@MonitorAUS



V1.0 - 250617



# MONITOR E209PX

The Monitor E290PX is a versatile 28.7 m telescopic truck mounted machine. An agile unit with amazing outreach!

The Waimea E290PX truck mounted lift is built to accommodate 2 persons and tools with a maximum rated capacity of 250 kg.

It is also equipped with hydraulic controls for lift and stabilisation functions, providing for a very smooth operation and accuracy even at full height and outreach.

The E290PX is great for applications where frequent set-ups are needed, in restricted locations with higher reach requirements.



**20.2m**  
WORKING HEIGHT





Boom does not protrude into traffic lane

Telescopic boom for point & shoot functionality.

Double pantograph boom with "plumbline" boom function.

Super smooth upper controls for precision operation.

Options include fire extinguisher, tool boxes, cabin protection & lighting

Super smooth upper controls for precision operation.

Straightdown outriggers

# TECHNICAL SPECIFICATIONS

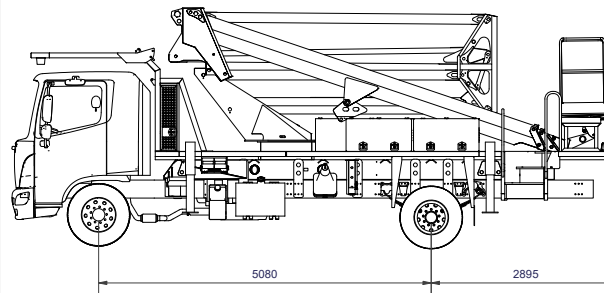
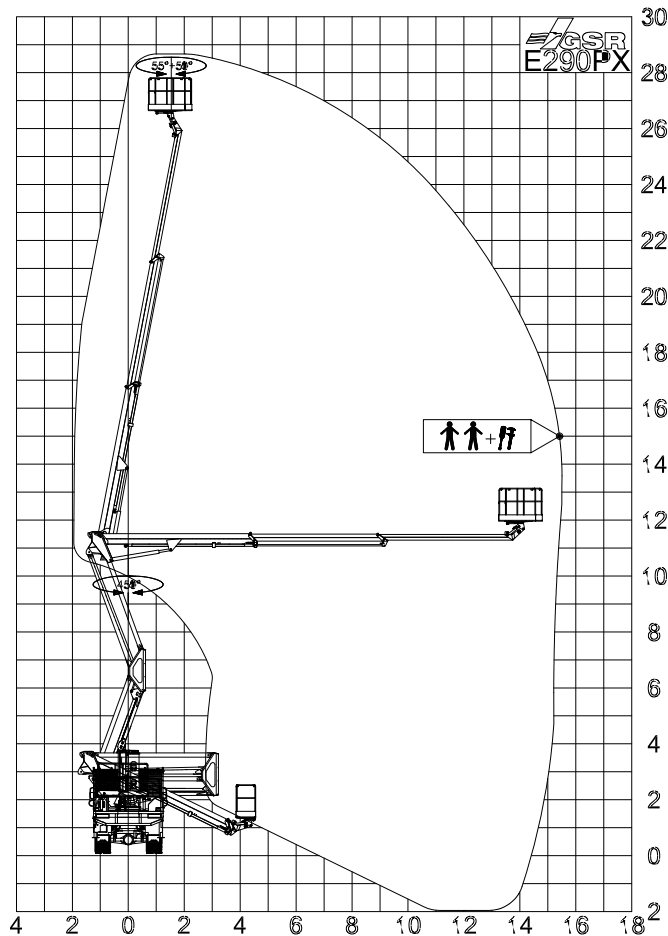

Max working height	28.7 m
Max platform height	26.7 m
Max horizontal reach	15.6 m
Max. rated capacity	2 persons / 250 kg
Boom Style	Articulating/Telescopic
Insulation	No
Basket rotation	140°
Turret rotation	450° Non Continuous
Control type	Hydraulic
Standard power source	PTO from vehicle

## TRUCK SPECIFICATIONS

Model	Hino FG1628
Specifications	4x2
HP	240
Transmission	AMT Auto
Difflocker/ Traction control	S

## WEIGHTS & DIMENSIONS ON BASE UNIT

GVM	16000 kg
Tare Weight	11410 kg
Payload max.	4590 kg
Length	9300 mm
Wheelbase	5080 mm
Height	3680 mm
Width	2500 mm

(All specs E&OE and subject to change)









—  
**minimised  
downtime  
guarantee\***  
—



# Our Locations

## Branches & Service Centres



### Tamworth

143 Gunnedah Rd  
Tamworth NSW 2340



### Sydney

49-50 Cassola Pl  
Penrith NSW 2740



### Melbourne

24-28 William Rd  
Dandenong South VIC 3175



### Brisbane

191 Magnesium Dr  
Crestmead QLD 4132



### Brisbane - Caboolture

2 Alta Road  
Caboolture QLD 4510



### Perth

11 Reihill Rd  
Maddington WA 6109

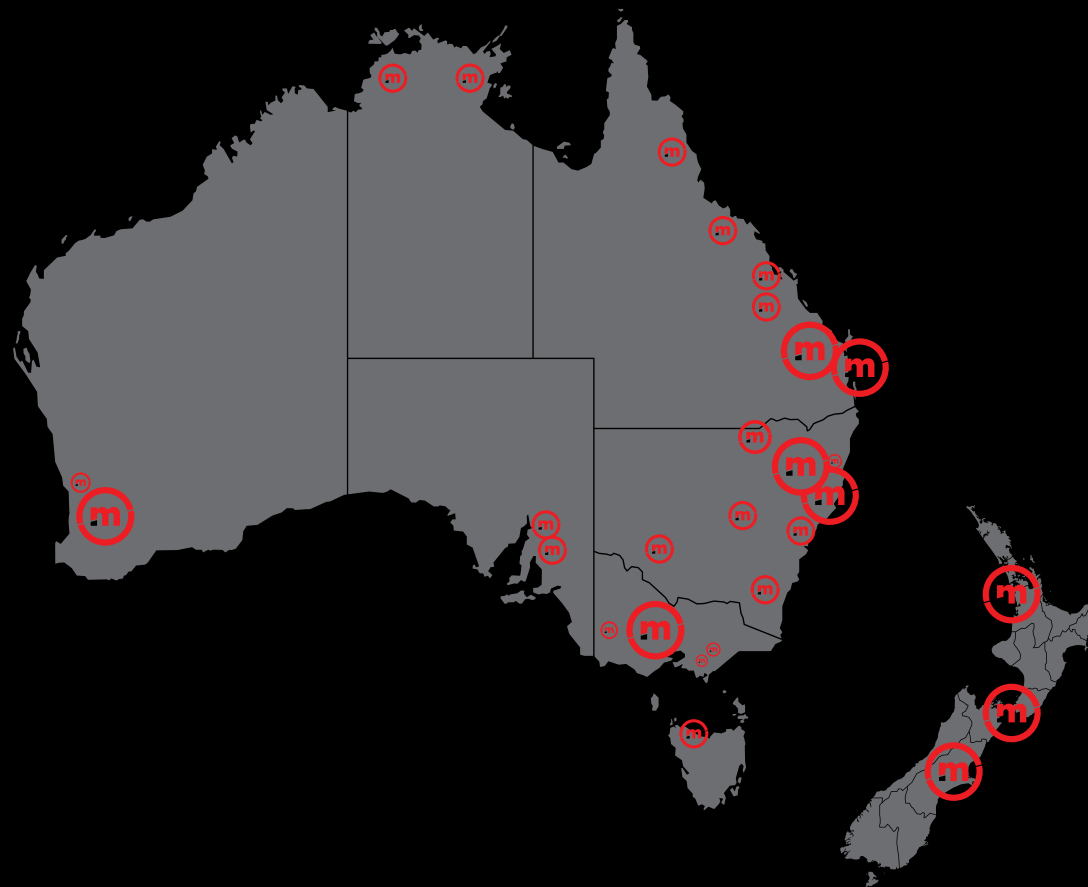

[agent@monitor.net.au](mailto:agent@monitor.net.au)

1800 025 024  
[monitor.net.au](http://monitor.net.au)

@MonitorAUS



**monitor**

the world's best equipment supported locally

Monitor E290PX Truck Mounted Lift - Hino FG1628